

SPECIFICATION KEY	
	<b>Q25110 - PAVING: NATURAL STONE PAVING</b> 900x600mm in random length of 200 x 400 x 600 mm flame-textured MID-GREY GRANITE paving 6mm joints to paving units to be filled with wet-lay mix jointing material to BS7533, colour neutral Sub-base to engineer's design detail and specification Apply two coats of clear wet look sealer to prevent staining
	<b>Q21115A - PAVING: EXPOSED AGGREGATE CONCRETE SURFACING</b> Aggregate: size maximum 10 and 20 rounded fine-washed gravel. Additional aggregate requirements: Aggregate size maximum 10 mm P.C. 20 mm P.C. 4. Maximum of 0.4% free aggregate washed sand and CRF dust by Klaron or EGA. Cement: Cemlink A, by Irish Cement and "GOSBY" by Ecocem or EGA. Admix: "Admix 411" by W. H. "Vibro" "Vibro" "Vibro" "Vibro" Construction Products & "155-12 Fibretek" by Curtis Enterprises or EGA. Colour: to match adjacent Additional mix requirements: "Vibro VBA Bio 2" or EGA vegetable-based surface retarder and curing agent for textured concrete landscaping Sub-base: 150 mm C20 concrete with reinforcement to engineer's specification Finish: Exposed aggregate surfacing Joints: 4mm wide Formed joints at 5 m centres, temporary forms, square edged with a steel top surface, placing concrete compact thoroughly at edges to give level, closely abutted joints with no topping Saw: Cut at min 300 mm, not less than one quarter the depth of the slab, in depth and as narrow as practicable. Sawing sufficiently early to prevent random cracking (within 24 hours of casting slab) and to produce strong, well defined joints across concrete paving slabs
	<b>TARMAC TO ENGINEER'S SPECIFICATION</b>
	<b>PERMEABLE PAVING TO ENGINEERS DETAILS &amp; SPECIFICATION</b>
	<b>HARD COMPACTING GOLDEN GRAVEL</b> 10mm spherical 3mm dust material to seal all interstices 50mm compacted depth golden-coloured limestone hard-compacting gravel (MAG or EGA)
	<b>PAVING</b> Modular paving strips to site topography shared surface
	<b>WET POUR IMPACT ABSORBING IN SITU SYNTHETIC SURFACING SPECIFICATION</b> Q25250 Surface course: Wet pour, in situ laid polyurethane bound EPDM rubber crumbs surface to BS 7188: Wet Pour Rubber Surfacing 'Base Course' or 'Shock Pad' is manufactured from 100% Recycled SBR (Styrene Butadiene Rubber) rubber crumbs which is mixed with a polyurethane resin binder. Colour: Yellow. Thickness: 40mm
	<b>Q30 - PLANTING: GRASS LAWN</b> Excavate lawn areas to 150mm depth & break up base of area to ensure free drainage Backfill with min. 150mm depth multi-purpose grade topsoil to BS3882 to lawn area Seed with low maintenance hard-wearing non-irrigation amenity grass seed mix at 25g per m² or approved wildflower meadow seed mix as indicated
	<b>RITTER GRASS TO SUPPORT TENDER ACCESS</b> GeoScope EcoBlock by Cooper Clarke Groups or EGA Recycled polypropylene geo-space ecoblock (colour green) 500x500x80mm deep with topsoil on 30mm sharp sand bedding on 200mm coarse 8/4 granular material on Tensar Triax TX 150 geogrid or equivalent
	<b>P1 - ORNAMENTAL SHRUBS AND PERENNIALS</b> Alcazar, Digitalis grandiflora, Iris foetidissima, Kniphofia 'Alcazar', Libertia grandiflora, Blechnum spicatum, Phyllis (Asplenium) scolopendrium Planting to 300mm depth BS3882 multi-purpose topsoil on free-draining sub-base, topped with 90gsm² black landscape fabric and 75mm depth medium-grade pine bark mulch Ornamental perennial planting to comprise flowering perennials & evergreen shrubs to soften the visual impact of the development
	<b>PLANTING - Miscanthus sinensis 'Malepartus'</b> 2 litre container grown 300mm depth BS3882 multi-purpose topsoil on free-draining sub-base, topped with 90gsm² black landscape fabric and 75mm depth medium-grade pine bark mulch
	<b>PLANTING - HEDGEROW:</b> Evergreen Yew (Taxus Baccata) Hedgerow maintained at 1m height to screen low level views of parked vehicles whilst allowing open uninterrupted views of the proposed development
	<b>Q31 - SEMI-MATURE NATIVE TREES</b> Semi-mature native species provided with 1200mm² multi-purpose grade topsoil to BS 3882, topped with black 90gsm² landscape fabric secured with plastic pegs at 300mm c/c & 75mm depth medium-grade bark mulch Trees double-staked & supplied with planting accessories, and provided with root restrictors within 2m of paving, underground services and foundations
	<b>Q31 - CLEAR-STEMMED TO 2M HEIGHT SEMI-MATURE TREES</b> Semi-mature trees provided with 1200mm² multi-purpose grade topsoil to BS 3882, topped with black 90gsm² landscape fabric secured with plastic pegs at 300mm c/c & 75mm depth medium-grade bark mulch Trees double-staked & supplied with planting accessories, and provided with root restrictors within 2m of paving, underground services and foundations
	<b>Q50/220A - WOODEN BENCH WITH BACKREST</b> 500mm width x 400mm depth x 350mm length planned smooth Grade A green Douglas Fir to 900mm height from FGL Timber to be FSC-certified and sourced sustainably Base frame of galvanneal mild steel (powder coated to RAL 8004 Copper brown) with stainless steel fasteners, bolted to C20P concrete foundation to engineer's specification, finished 100mm below FGL Seat and backrest of solid Douglas Fir ashwood Shop drawings to be produced by contractor prior to fabrication
	<b>Q50/253 - NATURAL STONE BOULDERS</b> 1000-1500mm Ø rounded natural stone glacial boulders of Irish granite or limestone grouped to act as single and grouped informal seating elements and features Set 100-200mm deep into landscape finish
	<b>COVERED BICYCLE STANDS</b> 200 no Covered cycle parking spaces located within communal courtyard spaces 60 no uncovered spaces along site frontage onto Naas road
	<b>EXIT STAIRWAY</b> Canopy above exit stair from basement car park and bicycle parking spaces
	<b>BOUNDARY TREATMENT</b> 1.8m height galvanneal mild steel bar railing painted grey on 400mm height plinth wall
	<b>BASEMENT VENTILATION</b> Galvanneal mild steel heelsafe grating

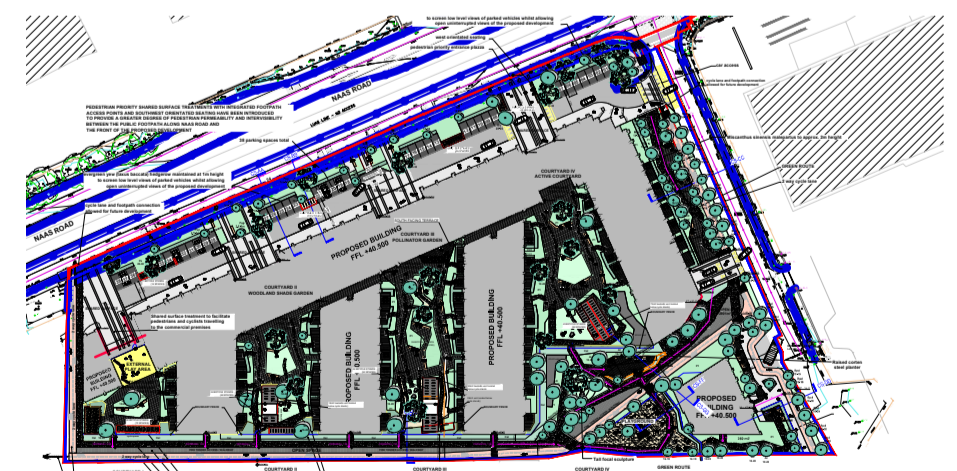

**STEPHEN DIAMOND ASSOCIATES**  
CHARTERED LANDSCAPE ARCHITECTS

68 Pearse Street Dublin 2 tel: 01 6775670  
email: mail@scada.ie fax: 01 6775669  
Client: Development 8  
Project: Concorde site  
Title: Master plan - Detail 02  
Dwg No: 18-489-PD-03 Date Issued: 2019-04-29 Scale: 1:200 @ A1  
Drawn: MA Purpose: Planning Checked: SD

**Level Notes:**  
EX+ Existing Level  
TL+ Top of Landscape Finish  
TP+ Top of Paving  
TK+ Top of Kerb  
TW+ Top of Walls  
TE+ Top of Edging

**Psp** - Prunus spinosa (Blackthorn)  
**Ps** - Pinus sylvestris (Scots Pine)  
**Bp** - Betula pubescens (Downy Birch)  
**Bpd** - Betula pendula (Silver Birch)  
**Ac** - Acer campestre 'Streetwise' (Field Maple)  
**AI** - Amelanchier lamarckii (Snowberry)

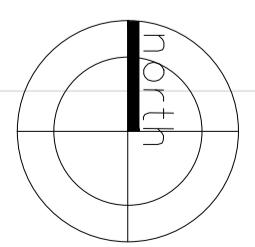

**COURTYARD I**  
cycle and pedestrian connections to Naas Road & commercial element of scheme  
cycle lane and footpath connection allowed for future development

**COURTYARD II**  
WOODLAND SHADE GARDEN  
Fence  
Ritter grass paving  
Fire tender access / Walkway  
Tree planting along southern site boundary

**COURTYARD III**  
POLLINATOR GARDEN  
Miscanthus sinensis malepartus to approx. 2m height  
Calamagrostis 'Karl Foerster' to approx. 1.5m height